

TABLE

**TABLE 1  
POTENTIAL OFF-SITE ENVIRONMENTAL CONCERNS**

1 & 7 Main Street  
East Haddam, Connecticut

Off-Site Property	Approximate Distance From Site	Where Concern Was Reported	Incident(s)
Connecticut River at East Haddam Bridge	Adjacent to west	Spill Reports	8-15-81 report of sewage in river at bridge. Coast Guard found no evidence of sewage. 5-2-95 report of diesel fuel sheen on river. Sheen dissipated. 9-5-95 report of oil slick on river. No sheen observed when inspection performed. 5-4-01 and 5-18-01 reports of sheen on river.
Goodspeed Opera House 6 Main Street	Across Main Street to south	Tank Registration LUST Spill Reports DEP Files	Registered following underground tanks: 3000-gal. heating oil tank (installed in 1963 and removed in 1989 and 2000-gal. heating oil tank (installed in 1989 and in use). 5-19-82 report of discharge of paint wastes into catch basin and river. 8-3-90 report of disposal of lead paint residue to river by contractor. Lead paint residue also in soil around building. DEP issued 1993 Notice of Violation to opera house for the improper disposal of paint wastes to septic systems. 2-2-98 report of leaking underground No. 2 heating oil tank. Tank and 5 cubic yards of contaminated soil removed.
Gelston House 8 Main Street	Across Main Street to south	DEP Files	1989 DEP Consent Order requiring operator of Gelston House to take actions to address failing septic system.
Williams Chevrolet 24 Lumberyard Road	150 feet east/southeast	Tank Registration DEP Files	Registered following underground tanks: 2000-gal. gasoline tank (installed in 1958 and abandoned in 1986), 4000-gal. gasoline tank (installed in 1958 and abandoned in 1986), and 2000-gal. gasoline tank (installed in 1972 and abandoned in 1986). Former occupant was East Haddam Service Garage where floor drainage discharge to Succor Brook was found by DEP inspector in 1969.
Dock Road	200 feet south	Spill Reports	12-27-00 report of spill of 750 gal. of raw sewage. Case open in DEP log book.
Intersection of Creamery Road and Norwich Road	300 feet east	Spill Reports	3-15-99 spill of 11 gal. of transformer oil with 2 ppm PCB content. Spill cleaned by Northeast utilities.
Area of Routes 82 and 149	300 feet east	DEP Map DEP Files	Septic system failures in area. DEP issued 1989 Abatement Order requiring the Town of East Haddam to identify and implement alternative wastewater disposal procedures. Town eventually extended sanitary sewers to the area.

**TABLE 1**  
**POTENTIAL OFF-SITE ENVIRONMENTAL CONCERNS**

1 & 7 Main Street  
East Haddam, Connecticut

Off-Site Property	Approximate Distance From Site	Where Concern Was Reported	Incident(s)
H.R. Engineering Labs, Inc. Norwich Road	1500 feet northeast	DEP Map DEP Files	Manufacture of castings and casting machines since 1950. Septic systems used on property at time of 1969 DEP inspection. Cooling water discharge shown on DEP Map.
Sibley Company Bridge Road Haddam	Across Connecticut River - 1500 feet west of site	TSDf	Hazardous waste disposal to metal hydroxide sludge drying beds and acid disposal pits. Remedial actions performed. Solvent contamination reported on property.

**APPENDICES**

**Appendix A**

Well Logs and Chemical Test Data  
from Draft Report by Land-Tech Consultants

# Soil Sampling Log

DATE STARTED	7/30/00
DATE FINISHED	8/1/00
WEIGHT OF HAMMER	140 Lbs.
HAMMER FALL	30"
GROUND WATER OBSERVATION	
DATE	7/30/00 -
TIME	0 Hours -
DEPTH	32-3" -
SAMPLER Dia (Type/O.D./I.D.)	SS 2" / 1-3/8"
TYPE OF RIG	CME 75 - Truck

**Connecticut Test Borings, LLC**  
 P.O. Box 69 - Seymour, CT 06483  
 GEOTECHNICAL & ENVIRONMENTAL DRILLING  
 (203) 888-3857 (203) 888-5777  
 FAX: (203) 888-0655

SHEET	1 OF 1
PROJECT No.	C00186
LOCATION	7 Main Street E. Haddam, CT
OFFSET	
GROUND ELEVATION	
HOLE No.	MW-1
CASING	HSA 3-1/4"
SAMPLER	FWC 4"
CORE BARREL	

ESPECIALLY COMPILED FOR  
**Land-Tech Consultants, Inc.**  
 205 Playhouse Corner  
 Southbury, CT 06488

C B A L S O P I W S H	D E P T H	S A M P L E D E P T H (FEET)	S A M P L E T Y P E	B L O W S P E R 6 I N C H E S O N S A M P L E R				D E N S I T Y O R C O N S I S T M O I S T U R E	P R O F I L E C H A N G E D E P T H E L E V.	F I E L D I D E N T I F I C A T I O N O F S O I L S  R E M A R K S	S A M P L E			B O R E / W E L L  (NOT TO SCALE)
				0-6	6-12	12-18	18-24				N O.	P E N	R E C	
									4"	TOPSOIL				
										BR. SILTY SAND & GRAEVL, OCC. COBBLES				
	-5	5'-47'	C					3.0	4'6"	BEDROCK				
								3.0						
								3.0						
								5.0						
								10.0		HOLLOW STEM AUGER REFUSAL AT '4'-6"				
	-10							6.0		DROVE 4" FWC '4'6"-5'				
								8.0		ROLLER BITTED '3-7/8" 5' TO 0				
								4.0						
								4.0						
								5.0						
								4.0						
	-15							5.0						
								6.0						
								4.0						
								5.0						
								6.0						
								4.0						
	-20							5.0						
								8.0						
								7.0						
								5.0						
								5.0						
								6.0						
								4.0						
	-25							6.0						
								6.0						
								9.0						
								6.0						
								8.0						
								8.0						
	-30							9.0						
								8.0						
								9.0						
								8.0						
								6.0						
								7.0						
	-35							6.0						
								6.0						
								8.0						
								4.0		SET 2" PVC WELL PIPE 47' BELOW GRADE				
								4.0		SCREEN -42' TO -28'				
	-40							5.0		RISER -47' TO -42'				
								4.0		RISER -28' TO -0'				
								3.0		SAND -47' TO -25'				
								3.0		BENT. -25' TO -22'				
								3.0		BACKFILL -22' TO -1'				
	-45							2.0		SAND MIX - 1' TO -0				
								3.0						
								4.0	47'					
	-50													

Proportions used: trace = 0-10%, little = 10-20%, some = 20-35%, and = 35-50%

DRILLER: **S.B.**  
 HELPER: **M.J.**  
 SOILS ENGINEER:  
 DRILLING INSPECTOR:

SAMPLE TYPE  
 C = CORED  
 W = WASHED  
 SS = SPLIT SPOON  
 UP = UNDISTURBED PISTON  
 TP = TEST PIT  
 UT = UNDISTURBED THINWALL

COHESIONLESS SOILS  
 0-4 VERY LOOSE  
 4-10 LOOSE  
 10-30 MEDIUM  
 30-50 DENSE  
 50+ VERY DENSE

COHESIVE SOILS  
 0-2 VERY SOFT  
 2-4 SOFT  
 4-8 MEDIUM  
 8-15 STIFF  
 15-30 VERY STIFF  
 30+ HARD

NOT RESPONSIBLE FOR SAMPLE STORAGE AFTER 30 DAYS

FILE: **C00186**

## Soil Sampling Log

**Connecticut Test Borings, LLC**

P.O. Box 69 - Seymour, CT 06483

GEOTECHNICAL & ENVIRONMENTAL DRILLING

(203) 888-3857 (203) 888-5777  
FAX: (203) 888-0655

SHEET **1** OF **1**

PROJECT No. **C00186**

LOCATION **7 Main Street  
E. Haddam, CT**

OFFSET

GROUND ELEVATION

HOLE No. **MW-2**

CASING **HSA 3-1/4"**

SAMPLER **FWC 4"**

CORE BARREL

ESPECIALLY COMPILED FOR  
**Land-Tech Consultants, Inc.**  
205 Playhouse Corner  
Southbury, CT 06488

DATE STARTED **7/28/00**  
DATE FINISHED **7/28/00**  
WEIGHT OF HAMMER **140 Lbs.**  
HAMMER FALL **30"**  
GROUND WATER OBSERVATION  
DATE **7/28/00** -  
TIME **0 Hours** -  
DEPTH **20'-6"** -  
SAMPLER Dia. (Type/O.D./I.D.) **SS 2" / 1-3/8"**  
TYPE OF RIG **CME 75 - Truck**

C B A L S O D I W S H G	D E P T H	S A M P L E D E P T H (F E E T)	S A M P L E T Y P E	B L O W S P E R 6 I N C H E S O N S A M P L E R				D E N S I T Y O R C O N S I S T M O I S T U R E	P R O F I L E C H A N G E D E P T H E L E V.	F I E L D I D E N T I F I C A T I O N O F S O I L  R E M A R K S	S A M P L E			B O R E / W E L L  (N O T T O S C A L E)	
				0-6	6-12	12-18	18-24				N O	P E N	R E C		
									2"	ASPHALT					
									6"	F-C GRAVEL BR. VF-F SAND, SOME SILT, TR. F-M GRAVEL					
	-5	5'-7'	SS	2	2	1	2	V. LOOSE MOIST				1	24	18	
	-10	9'-29'	C					6.0 5.0 14.0 5.0 6.0 12.0 9.0 11.0 5.0 6.0 5.0 7.0 6.0 10.0 8.0 5.0 6.0 4.0 7.0	8'	BEDROCK HOLLOW STEM AUGER REFUSAL AT '9' ROLLER BITTED 3-7/8" 9' TO 29'					
	-20														
	-25														
	-30								29'	BOTTOM OF BORING					
	-35									SET 2" PVC WELL PIPE 29' BELOW GRADE					
	-40									SCREEN -29' TO -14' RISER -14' TO -0' SAND -29' TO -13' BENTONITE -13' TO -8' BACKFILL -8' TO -1' SAND MIX -1' TO -0'					
	-45														
	-50														

Proportions used: trace = 0-10%, little = 10-20%, some = 20-35%, and = 35-50%

DRILLER: **S.B.**  
HELPER: **M.J.**  
SOILS ENGINEER:  
DRILLING INSPECTOR:

NOT RESPONSIBLE FOR SAMPLE STORAGE AFTER 30 DAYS

SAMPLE TYPE  
C = CORED  
W = WASHED  
SS = SPLIT SPOON  
UP = UNDISTURBED PISTON  
TP = TEST PIT  
UT = UNDISTURBED THINWALL

COHESIONLESS SOILS  
0-4 VERY LOOSE  
4-10 LOOSE  
10-30 MEDIUM  
30-50 DENSE  
50+ VERY DENSE

COHESIVE SOILS  
0-2 VERY SOFT  
2-4 SOFT  
4-8 MEDIUM  
8-15 STIFF  
15-30 VERY STIFF  
30+ HARD

FILE: **C00186**

# Soil Sampling Log

**Connecticut Test Borings, LLC**

P.O. Box 69 - Seymour, CT 06483

GEOTECHNICAL & ENVIRONMENTAL DRILLING  
(203) 888-3857 (203) 888-5777  
FAX: (203) 888-0655



DATE STARTED	8/1/00		
DATE FINISHED	8/1/00		
WEIGHT OF HAMMER	140 Lbs.		
HAMMER FALL	30"		
GROUND WATER OBSERVATION			
DATE	8/1/00	-	-
TIME	0 Hours	-	-
DEPTH	8'-0"	-	-
SAMPLER Dia. (Type/O.D./I.D.)	SS 2" / 1-3/8"		
TYPE OF RIG	CME 75 - Truck		

ESPECIALLY COMPILED FOR  
**Land-Tech Consultants, Inc.**  
205 Playhouse Corner  
Southbury, CT 06488

SHEET	1 OF 1		
PROJECT No.	C00186		
LOCATION	7 Main Street E. Haddam, CT		
OFFSET			
GROUND ELEVATION			
HOLE No.	MW-3		
CASING	HSA	3-1/4"	
SAMPLER	FWC	4"	
CORE BARREL			

C A L S O I P I N G S	D E P T H	S A M P L E D E P T H (FEET)	S A M P L E T Y P E	B L O W S P E R 6 I N C H E S O N S A M P L E R				D E N S I T Y O R C O N S I S T M O I S T U R E	P R O F I L E C H A N G E D E P T H E L E V.	F I E L D I D E N T I F I C A T I O N O F S O I L S  R E M A R K S	S A M P L E			B O R E / W E L L  (NOT TO SCALE)	
				0-6	6-12	12-18	18-24				N O.	P E N	R E C		
									2'	BROWN SILTY SAND & GRAEVL (FILL) TAN VF-F SAND, L. SILT					
	-5	5'-7"	SS	4	3	5	5	LOOSE DAMP			1	24	17		
	-10	10'-12'	SS	3	6	8	7	MEDIUM WET		SAME W/ SOME SILT	2	24	20		
	-15														
	-20								20'	BOTTOM OF BORING					
	-25														
	-30														
	-35														
	-40									SET 2" PVC WELL PIPE 20' BELOW GRADE					
	-45									SCREEN -20' TO -5' RISER -5' TO -1' SAND -20' TO -4' BENTONITE -4' TO -3' BACKFILL -3' TO -1' SAND MIX -1' TO -0'					
	-50														

Proportions used: trace = 0-10%, little = 10-20%, some = 20-35%, and = 35-50%

DRILLER: **S.B.**  
HELPER: **M.J.**  
SOILS ENGINEER:  
DRILLING INSPECTOR:

SAMPLE TYPE  
C = CORED  
W = WASHED  
SS = SPLIT SPOON  
UP = UNDISTURBED PISTON  
TP = TEST PIT  
UT = UNDISTURBED THINWALL

COHESIONLESS SOILS  
0-4 VERY LOOSE  
4-10 LOOSE  
10-30 MEDIUM  
30-50 DENSE  
50+ VERY DENSE

COHESIVE SOILS  
0-2 VERY SOFT  
2-4 SOFT  
4-8 MEDIUM  
8-15 STIFF  
15-30 VERY STIFF  
30+ HARD

NOT RESPONSIBLE FOR SAMPLE STORAGE AFTER 30 DAYS

FILE: **C00186**



## Soil Sampling Log

DATE STARTED	8/1/00		
DATE FINISHED	8/1/00		
WEIGHT OF HAMMER	140 Lbs.		
HAMMER FALL	30"		
GROUND WATER OBSERVATION			
DATE	8/1/00	-	
TIME	0 Hours	-	
DEPTH	Dry	-	
SAMPLER Dia. (Type/O.D./I.D.)	SS 2" / 1-3/8"		
TYPE OF RIG	CME 75 - Truck		

**Connecticut Test Borings, LLC**  
 P.O. Box 69 - Seymour, CT 06483  
 GEOTECHNICAL & ENVIRONMENTAL DRILLING  
 (203) 888-3857 (203) 888-5777  
 FAX: (203) 888-0655



SHEET	1 OF 1		
PROJECT No.	C00186		
LOCATION	7 Main Street E. Haddam, CT		
OFFSET			
GROUND ELEVATION			
HOLE No	MW-4		
CASING	HSA	3-1/4"	
SAMPLER	FWC	4"	
CORE BARREL			

ESPECIALLY COMPILED FOR  
**Land-Tech Consultants, Inc.**  
 205 Playhouse Corner  
 Southbury, CT 06488

C B A L S O I P I N G S	D E P T H	SAMPLE DEPTH (FEET)	SAMP TYPE	BLOWS PER 6 INCHES ON SAMPLER				DENSITY OR CONSIST MOISTURE	PROFILE CHANGE DEPTH ELEV	FIELD IDENTIFICATION OF SOILS  REMARKS	SAMPLE			BORE / WELL  (NOT TO SCALE)
				0-6	6-12	12-18	18-24				NO.	PEN	REC	
								2'	BR. SILTY SAND, L. F-C GRAVEL (FILL) TAN VF-F SAND, TR. SILT					
	-5	5'-7'	SS	4	6	5	8	MEDIUM DRY			1	24	16	
	-10	10'-12'	SS	12	50/5			V.DENSE MOIST	8'6" 10'3" 10'5"	BR. VF-F SAND, SOME SILT, L. F-C GRAVEL (TILL) PROBABLE BEDROCK REFUSAL	2	11	10	
	-15													
	-20													
	-25													
	-30													
	-35													
	-40													
	-45													
	-50													

Proportions used: trace = 0-10%, little = 10-20%, some = 20-35%, and = 35-50%

DRILLER: **S.B.**  
 HELPER: **M.J.**  
 SOILS ENGINEER:  
 DRILLING INSPECTOR:

SAMPLE TYPE  
 C = CORED  
 W = WASHED  
 SS = SPLIT SPOON  
 UP = UNDISTURBED PISTON  
 TP = TEST PIT  
 UT = UNDISTURBED THINWALL

COHESIONLESS SOILS  
 0-4 VERY LOOSE  
 4-10 LOOSE  
 10-30 MEDIUM  
 30-50 DENSE  
 50+ VERY DENSE

COHESIVE SOILS  
 0-2 VERY SOFT  
 2-4 SOFT  
 4-8 MEDIUM  
 8-15 STIFF  
 15-30 VERY STIFF  
 30+ HARD

NOT RESPONSIBLE FOR SAMPLE STORAGE AFTER 30 DAYS

FILE: **C00186**

ALPHA ANALYTICAL LABORATORIES

Eight Walkup Drive  
Westborough, Massachusetts 01581-1019  
(508) 898-9220

MA:M-MA-086 NH:200395-B/C CT:PH-0574 ME:MA086 RI:65 NY:11148

CERTIFICATE OF ANALYSIS

Client: Land-Tech Consultants	Laboratory Job Number: L0006658
Address: 205 Playhouse Corner	Invoice Number: 40172
Southbury, CT 06488	Date Received: 10-AUG-00
Attn: M. Bartos	Date Reported: 23-AUG-00
Project Number: E00199-04	Delivery Method: Alpha
Site: 7 MAIN ST.	

---

ALPHA SAMPLE NUMBER	CLIENT IDENTIFICATION	SAMPLE LOCATION
L0006658-01	MW-1	E. HADDAM, CT
L0006658-02	MW-2	E. HADDAM, CT
L0006658-03	MW-3	E. HADDAM, CT
L0006658-04	TRIP BLANK	ALPHA

I attest under the pains and penalties of perjury that, based upon my inquiry of those individuals immediately responsible for obtaining the information, the material contained in this report is, to the best of my knowledge and belief, accurate and complete. This certificate of analysis is not complete unless this page accompanies any and all pages of this report.

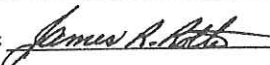
Authorized by: 

James R. Roth, PhD - Laboratory Manager

ALPHA ANALYTICAL LABORATORIES  
 CERTIFICATE OF ANALYSIS

MA:M-MA-086 NH:200395-B/C CT:PH-0574 ME:MA086 RI:65

Laboratory Sample Number: L0006658-01 Date Collected: 09-AUG-2000  
 MW-1 Date Received: 10-AUG-2000  
 Sample Matrix: WATER Date Reported: 23-AUG-00  
 Condition of Sample: Satisfactory Field Prep: None  
 Number & Type of Containers: 2-Amber,1-Plastic,2-Vial

PARAMETER	RESULT	UNITS	RDL	REF	METHOD	DATES		ID
						PREP	ANALYSIS	
Hydrocarbons, Total (IR)	1.8	mg/l	0.95	4	418.1	22-Aug	23-Aug	TH
Total Metals				1	3015			
Arsenic, Total	0.016	mg/l	0.005	1	6010B	17-Aug	19-Aug	RW
Barium, Total	0.18	mg/l	0.01	1	6010B	17-Aug	19-Aug	RW
Cadmium, Total	ND	mg/l	0.005	1	6010B	17-Aug	19-Aug	RW
Chromium, Total	0.20	mg/l	0.01	1	6010B	17-Aug	19-Aug	RW
Lead, Total	ND	mg/l	0.05	1	6010B	17-Aug	19-Aug	RW
Mercury, Total	ND	mg/l	0.0005	1	7470A	15-Aug	16-Aug	DM
Selenium, Total	ND	mg/l	0.005	1	6010B	17-Aug	19-Aug	RW
Silver, Total	ND	mg/l	0.010	1	6010B	17-Aug	19-Aug	RW
Volatile Organics by GC/MS 8260				1	8260B			18-Aug AM
Methylene chloride	ND	ug/l	5.0					
1,1-Dichloroethane	ND	ug/l	1.5					
Chloroform	2.0	ug/l	1.5					
Carbon tetrachloride	ND	ug/l	1.0					
1,2-Dichloropropane	ND	ug/l	3.5					
Dibromochloromethane	ND	ug/l	1.0					
1,1,2-Trichloroethane	ND	ug/l	1.5					
Tetrachloroethene	ND	ug/l	1.0					
Chlorobenzene	ND	ug/l	3.5					
Trichlorofluoromethane	ND	ug/l	5.0					
1,2-Dichloroethane	ND	ug/l	1.0					
1,1,1-Trichloroethane	ND	ug/l	1.0					
Bromodichloromethane	ND	ug/l	1.0					
trans-1,3-Dichloropropene	ND	ug/l	1.0					
cis-1,3-Dichloropropene	ND	ug/l	1.0					
1,1-Dichloropropene	ND	ug/l	25.					
Bromoform	ND	ug/l	1.0					
1,1,2,2-Tetrachloroethane	ND	ug/l	1.0					
Benzene	ND	ug/l	1.0					
Toluene	5.5	ug/l	1.5					
Ethylbenzene	ND	ug/l	1.0					
Chloromethane	ND	ug/l	10.					
Bromomethane	ND	ug/l	2.0					
Vinyl chloride	ND	ug/l	2.0					

Comments: Complete list of References and Glossary of Terms found in Addendum I

ALPHA ANALYTICAL LABORATORIES  
CERTIFICATE OF ANALYSIS

Laboratory Sample Number: L0006658-01  
MW-1

PARAMETER	RESULT	UNITS	RDL	REF	METHOD	DATES PREP ANALYSIS	ID
Volatile Organics by GC/MS 8260 continued				1	8260B	18-Aug	AM
Chloroethane	ND	ug/l	2.0				
1,1-Dichloroethene	ND	ug/l	1.5				
trans-1,2-Dichloroethene	ND	ug/l	1.5				
Trichloroethene	ND	ug/l	1.0				
1,2-Dichlorobenzene	ND	ug/l	5.0				
1,3-Dichlorobenzene	ND	ug/l	5.0				
1,4-Dichlorobenzene	ND	ug/l	5.0				
Methyl tert butyl ether	ND	ug/l	10.				
p/m-Xylene	ND	ug/l	1.0				
o-Xylene	ND	ug/l	1.0				
cis-1,2-Dichloroethene	ND	ug/l	1.0				
Dibromomethane	ND	ug/l	10.				
1,4-Dichlorobutane	ND	ug/l	10.				
Iodomethane	ND	ug/l	10.				
1,2,3-Trichloropropane	ND	ug/l	10.				
Styrene	ND	ug/l	1.0				
Dichlorodifluoromethane	ND	ug/l	10.				
Acetone	ND	ug/l	10.				
Carbon disulfide	ND	ug/l	10.				
2-Butanone	ND	ug/l	10.				
Vinyl acetate	ND	ug/l	10.				
4-Methyl-2-pentanone	ND	ug/l	10.				
2-Hexanone	ND	ug/l	10.				
Ethyl methacrylate	ND	ug/l	10.				
Acrolein	ND	ug/l	25.				
Acrylonitrile	ND	ug/l	10.				
Bromochloromethane	ND	ug/l	5.0				
Tetrahydrofuran	ND	ug/l	20.				
2,2-Dichloropropane	ND	ug/l	5.0				
1,2-Dibromoethane	ND	ug/l	5.0				
1,3-Dichloropropane	ND	ug/l	5.0				
1,1,1,2-Tetrachloroethane	ND	ug/l	5.0				
Bromobenzene	ND	ug/l	5.0				
n-Butylbenzene	ND	ug/l	5.0				
sec-Butylbenzene	ND	ug/l	5.0				
tert-Butylbenzene	ND	ug/l	5.0				
o-Chlorotoluene	ND	ug/l	5.0				
p-Chlorotoluene	ND	ug/l	5.0				
1,2-Dibromo-3-chloropropane	ND	ug/l	5.0				
Hexachlorobutadiene	ND	ug/l	5.0				
Isopropylbenzene	ND	ug/l	5.0				
p-Isopropyltoluene	ND	ug/l	5.0				
Naphthalene	ND	ug/l	5.0				
n-Propylbenzene	ND	ug/l	5.0				
1,2,3-Trichlorobenzene	ND	ug/l	5.0				
1,2,4-Trichlorobenzene	ND	ug/l	5.0				
1,3,5-Trimethylbenzene	ND	ug/l	5.0				
1,2,4-Trimethylbenzene	ND	ug/l	5.0				
trans-1,4-Dichloro-2-butene	ND	ug/l	5.0				

Comments: Complete list of References and Glossary of Terms found in Addendum I

ALPHA ANALYTICAL LABORATORIES  
 CERTIFICATE OF ANALYSIS

Laboratory Sample Number: L0006658-01  
 MW-1

PARAMETER	RESULT	UNITS	RDL	REF	METHOD	DATES PREP ANALYSIS	ID
Volatile Organics by GC/MS 8260 continued							
Ethyl ether	ND	ug/l	25.	1	8260B	18-Aug AM	
Surrogate Recovery							
1,2-Dichloroethane-d4	113.	%					
Toluene-d8	96.0	%					
4-Bromofluorobenzene	98.0	%					
Dibromofluoromethane	111.	%					

Comments: Complete list of References and Glossary of Terms found in Addendum I

ALPHA ANALYTICAL LABORATORIES  
 CERTIFICATE OF ANALYSIS

MA:M-MA-086 NH:200395-B/C CT:PH-0574 ME:MA086 RI:65

Laboratory Sample Number: L0006658-02 Date Collected: 09-AUG-2000  
 MW-2 Date Received : 10-AUG-2000  
 Sample Matrix: WATER Date Reported : 23-AUG-00  
 Condition of Sample: Satisfactory Field Prep: None  
 Number & Type of Containers: 2-Amber,1-Plastic,2-Vial

PARAMETER	RESULT	UNITS	RDL	REF	METHOD	DATES PREP ANALYSIS	ID
Hydrocarbons, Total (IR)	1.4	mg/l	0.95	4	418.1	22-Aug 23-Aug	TH
Total Metals				1	3015		
Arsenic, Total	0.047	mg/l	0.005	1	6010B	17-Aug 19-Aug	RW
Barium, Total	0.38	mg/l	0.01	1	6010B	17-Aug 19-Aug	RW
Cadmium, Total	ND	mg/l	0.005	1	6010B	17-Aug 19-Aug	RW
Chromium, Total	0.25	mg/l	0.01	1	6010B	17-Aug 19-Aug	RW
Lead, Total	0.57	mg/l	0.05	1	6010B	17-Aug 19-Aug	RW
Mercury, Total	ND	mg/l	0.0005	1	7470A	15-Aug 16-Aug	DM
Selenium, Total	ND	mg/l	0.005	1	6010B	17-Aug 19-Aug	RW
Silver, Total	ND	mg/l	0.010	1	6010B	17-Aug 19-Aug	RW
Volatile Organics by GC/MS 8260				1	8260B		19-Aug AM
Methylene chloride	ND	ug/l	5.0				
1,1-Dichloroethane	ND	ug/l	1.5				
Chloroform	1.9	ug/l	1.5				
Carbon tetrachloride	ND	ug/l	1.0				
1,2-Dichloropropane	ND	ug/l	3.5				
Dibromochloromethane	ND	ug/l	1.0				
1,1,2-Trichloroethane	ND	ug/l	1.5				
Tetrachloroethene	ND	ug/l	1.0				
Chlorobenzene	ND	ug/l	3.5				
Trichlorofluoromethane	ND	ug/l	5.0				
1,2-Dichloroethane	ND	ug/l	1.0				
1,1,1-Trichloroethane	ND	ug/l	1.0				
Bromodichloromethane	ND	ug/l	1.0				
trans-1,3-Dichloropropene	ND	ug/l	1.0				
cis-1,3-Dichloropropene	ND	ug/l	1.0				
1,1-Dichloropropene	ND	ug/l	25.				
Bromoform	ND	ug/l	1.0				
1,1,2,2-Tetrachloroethane	ND	ug/l	1.0				
Benzene	ND	ug/l	1.0				
Toluene	ND	ug/l	1.5				
Ethylbenzene	ND	ug/l	1.0				
Chloromethane	ND	ug/l	10.				
Bromomethane	ND	ug/l	2.0				
Vinyl chloride	ND	ug/l	2.0				

Comments: Complete list of References and Glossary of Terms found in Addendum I

ALPHA ANALYTICAL LABORATORIES  
CERTIFICATE OF ANALYSIS

Laboratory Sample Number: L0006658-02  
MW-2

PARAMETER	RESULT	UNITS	RDL	REF	METHOD	DATES PREP ANALYSIS	ID
Volatile Organics by GC/MS 8260 continued				1	8260B	19-Aug AM	
Chloroethane	ND	ug/l	2.0				
1,1-Dichloroethene	ND	ug/l	1.5				
trans-1,2-Dichloroethene	ND	ug/l	1.5				
Trichloroethene	ND	ug/l	1.0				
1,2-Dichlorobenzene	ND	ug/l	5.0				
1,3-Dichlorobenzene	ND	ug/l	5.0				
1,4-Dichlorobenzene	ND	ug/l	5.0				
Methyl tert butyl ether	ND	ug/l	10.				
p/m-Xylene	ND	ug/l	1.0				
o-Xylene	ND	ug/l	1.0				
cis-1,2-Dichloroethene	ND	ug/l	1.0				
Dibromomethane	ND	ug/l	10.				
1,4-Dichlorobutane	ND	ug/l	10.				
Iodomethane	ND	ug/l	10.				
1,2,3-Trichloropropane	ND	ug/l	10.				
Styrene	ND	ug/l	1.0				
Dichlorodifluoromethane	ND	ug/l	10.				
Acetone	ND	ug/l	10.				
Carbon disulfide	ND	ug/l	10.				
2-Butanone	ND	ug/l	10.				
Vinyl acetate	ND	ug/l	10.				
1-Methyl-2-pentanone	ND	ug/l	10.				
2-Hexanone	ND	ug/l	10.				
Ethyl methacrylate	ND	ug/l	10.				
Acrolein	ND	ug/l	25.				
Acrylonitrile	ND	ug/l	10.				
Bromochloromethane	ND	ug/l	5.0				
Tetrahydrofuran	ND	ug/l	20.				
2,2-Dichloropropane	ND	ug/l	5.0				
1,2-Dibromoethane	ND	ug/l	5.0				
1,3-Dichloropropane	ND	ug/l	5.0				
1,1,1,2-Tetrachloroethane	ND	ug/l	5.0				
Bromobenzene	ND	ug/l	5.0				
n-Butylbenzene	ND	ug/l	5.0				
sec-Butylbenzene	ND	ug/l	5.0				
tert-Butylbenzene	ND	ug/l	5.0				
o-Chlorotoluene	ND	ug/l	5.0				
p-Chlorotoluene	ND	ug/l	5.0				
1,2-Dibromo-3-chloropropane	ND	ug/l	5.0				
Hexachlorobutadiene	ND	ug/l	5.0				
Isopropylbenzene	ND	ug/l	5.0				
p-Isopropyltoluene	ND	ug/l	5.0				
Naphthalene	ND	ug/l	5.0				
n-Propylbenzene	ND	ug/l	5.0				
1,2,3-Trichlorobenzene	ND	ug/l	5.0				
1,2,4-Trichlorobenzene	ND	ug/l	5.0				
1,3,5-Trimethylbenzene	ND	ug/l	5.0				
1,2,4-Trimethylbenzene	ND	ug/l	5.0				
trans-1,4-Dichloro-2-butene	ND	ug/l	5.0				

Comments: Complete list of References and Glossary of Terms found in Addendum I

ALPHA ANALYTICAL LABORATORIES  
CERTIFICATE OF ANALYSIS

Laboratory Sample Number: L0006658-02  
MW-2

PARAMETER	RESULT	UNITS	RDL	REF	METHOD	DATES PREP ANALYSIS	ID
Volatile Organics by GC/MS 8260 continued							
Ethyl ether	ND	ug/l	25.	1	8260B	19-Aug	AM
Surrogate Recovery							
1,2-Dichloroethane-d4	114.	%					
Toluene-d8	94.0	%					
4-Bromofluorobenzene	99.0	%					
Dibromofluoromethane	113.	%					

Comments: Complete list of References and Glossary of Terms found in Addendum I



ALPHA ANALYTICAL LABORATORIES  
CERTIFICATE OF ANALYSIS

MA:M-MA-086 NH:200395-B/C CT:PH-0574 ME:MA086 RI:65

Laboratory Sample Number: L0006658-03  
MW-3  
Sample Matrix: WATER

Date Collected: 09-AUG-2000  
Date Received : 10-AUG-2000  
Date Reported : 23-AUG-00

Condition of Sample: Satisfactory

Field Prep: None

Number & Type of Containers: 2-Amber,1-Plastic,2-Vial

PARAMETER	RESULT	UNITS	RDL	REF	METHOD	DATES		ID
						PREP	ANALYSIS	
Hydrocarbons, Total (IR)	ND	mg/l	0.95	4	418.1	22-Aug	23-Aug	TH
Total Metals				1	3015			
Arsenic, Total	ND	mg/l	0.005	1	6010B	17-Aug	19-Aug	RW
Barium, Total	0.03	mg/l	0.01	1	6010B	17-Aug	19-Aug	RW
Cadmium, Total	ND	mg/l	0.005	1	6010B	17-Aug	19-Aug	RW
Chromium, Total	ND	mg/l	0.01	1	6010B	17-Aug	19-Aug	RW
Lead, Total	ND	mg/l	0.05	1	6010B	17-Aug	19-Aug	RW
Mercury, Total	ND	mg/l	0.0005	1	7470A	15-Aug	16-Aug	DM
Selenium, Total	ND	mg/l	0.005	1	6010B	17-Aug	19-Aug	RW
silver, Total	ND	mg/l	0.010	1	6010B	17-Aug	19-Aug	RW
Volatile Organics by GC/MS 8260								
				1	8260B			19-Aug AM
Methylene chloride	ND	ug/l	5.0					
1,1-Dichloroethane	ND	ug/l	1.5					
Chloroform	ND	ug/l	1.5					
Carbon tetrachloride	ND	ug/l	1.0					
1,2-Dichloropropane	ND	ug/l	3.5					
Dibromochloromethane	ND	ug/l	1.0					
1,1,2-Trichloroethane	ND	ug/l	1.5					
Tetrachloroethene	ND	ug/l	1.0					
Chlorobenzene	ND	ug/l	3.5					
Trichlorofluoromethane	ND	ug/l	5.0					
1,2-Dichloroethane	ND	ug/l	1.0					
1,1,1-Trichloroethane	ND	ug/l	1.0					
Bromodichloromethane	ND	ug/l	1.0					
trans-1,3-Dichloropropene	ND	ug/l	1.0					
cis-1,3-Dichloropropene	ND	ug/l	1.0					
1,1-Dichloropropene	ND	ug/l	25.					
Bromoform	ND	ug/l	1.0					
1,1,2,2-Tetrachloroethane	ND	ug/l	1.0					
Benzene	ND	ug/l	1.0					
Toluene	ND	ug/l	1.5					
Ethylbenzene	ND	ug/l	1.0					
Chloromethane	ND	ug/l	10.					
Bromomethane	ND	ug/l	2.0					
Vinyl chloride	ND	ug/l	2.0					

Comments: Complete list of References and Glossary of Terms found in Addendum I

ALPHA ANALYTICAL LABORATORIES  
CERTIFICATE OF ANALYSIS

Laboratory Sample Number: L0006658-03  
MW-3

PARAMETER	RESULT	UNITS	RDL	REF	METHOD	DATES PREP ANALYSIS	ID
Volatile Organics by GC/MS 8260 continued				1	8260B	19-Aug	AM
Chloroethane	ND	ug/l	2.0				
1,1-Dichloroethene	ND	ug/l	1.5				
trans-1,2-Dichloroethene	ND	ug/l	1.5				
Trichloroethene	ND	ug/l	1.0				
1,2-Dichlorobenzene	ND	ug/l	5.0				
1,3-Dichlorobenzene	ND	ug/l	5.0				
1,4-Dichlorobenzene	ND	ug/l	5.0				
Methyl tert butyl ether	ND	ug/l	10.				
p/m-Xylene	ND	ug/l	1.0				
o-Xylene	ND	ug/l	1.0				
cis-1,2-Dichloroethene	ND	ug/l	1.0				
Dibromomethane	ND	ug/l	10.				
1,4-Dichlorobutane	ND	ug/l	10.				
Iodomethane	ND	ug/l	10.				
1,2,3-Trichloropropane	ND	ug/l	10.				
Styrene	ND	ug/l	1.0				
Dichlorodifluoromethane	ND	ug/l	10.				
Acetone	ND	ug/l	10.				
Carbon disulfide	ND	ug/l	10.				
2-Butanone	ND	ug/l	10.				
Vinyl acetate	ND	ug/l	10.				
4-Methyl-2-pentanone	ND	ug/l	10.				
2-Hexanone	ND	ug/l	10.				
Ethyl methacrylate	ND	ug/l	10.				
Acrolein	ND	ug/l	25.				
Acrylonitrile	ND	ug/l	10.				
Bromochloromethane	ND	ug/l	5.0				
Tetrahydrofuran	ND	ug/l	20.				
2,2-Dichloropropane	ND	ug/l	5.0				
1,2-Dibromoethane	ND	ug/l	5.0				
1,3-Dichloropropane	ND	ug/l	5.0				
1,1,1,2-Tetrachloroethane	ND	ug/l	5.0				
Bromobenzene	ND	ug/l	5.0				
n-Butylbenzene	ND	ug/l	5.0				
sec-Butylbenzene	ND	ug/l	5.0				
tert-Butylbenzene	ND	ug/l	5.0				
o-Chlorotoluene	ND	ug/l	5.0				
p-Chlorotoluene	ND	ug/l	5.0				
1,2-Dibromo-3-chloropropane	ND	ug/l	5.0				
Hexachlorobutadiene	ND	ug/l	5.0				
Isopropylbenzene	ND	ug/l	5.0				
p-Isopropyltoluene	ND	ug/l	5.0				
Naphthalene	ND	ug/l	5.0				
n-Propylbenzene	ND	ug/l	5.0				
1,2,3-Trichlorobenzene	ND	ug/l	5.0				
1,2,4-Trichlorobenzene	ND	ug/l	5.0				
1,3,5-Trimethylbenzene	ND	ug/l	5.0				
1,2,4-Trimethylbenzene	ND	ug/l	5.0				
trans-1,4-Dichloro-2-butene	ND	ug/l	5.0				

Comments: Complete list of References and Glossary of Terms found in Addendum I

ALPHA ANALYTICAL LABORATORIES  
CERTIFICATE OF ANALYSIS

Laboratory Sample Number: L0006658-03  
MW-3

PARAMETER	RESULT	UNITS	RDL	REF	METHOD	DATES PREP ANALYSIS	ID
Volatile Organics by GC/MS 8260 continued							
Ethyl ether	ND	ug/l	25.	1	8260B	19-Aug	AM
Surrogate Recovery							
1,2-Dichloroethane-d4	109.	%					
Toluene-d8	107.	%					
4-Bromofluorobenzene	97.0	%					
Dibromofluoromethane	110.	%					

Comments: Complete list of References and Glossary of Terms found in Addendum I

ALPHA ANALYTICAL LABORATORIES  
 CERTIFICATE OF ANALYSIS

MA:M-MA-086 NH:200395-B/C CT:PH-0574 ME:MA086 RI:65

Laboratory Sample Number: L0006658-04

Date Collected: 24-JUL-2000

TRIP BLANK

Date Received : 10-AUG-2000

Sample Matrix:

WATER

Date Reported : 23-AUG-00

Condition of Sample: Satisfactory

Field Prep: None

Number & Type of Containers: 1-Vial

PARAMETER	RESULT	UNITS	RDL	REF	METHOD	DATES PREP ANALYSIS	ID
Volatile Organics by GC/MS 8260				1	8260B	19-Aug	BT
Methylene chloride	ND	ug/l	5.0				
1,1-Dichloroethane	ND	ug/l	1.5				
Chloroform	ND	ug/l	1.5				
Carbon tetrachloride	ND	ug/l	1.0				
1,2-Dichloropropane	ND	ug/l	3.5				
Dibromochloromethane	ND	ug/l	1.0				
1,1,2-Trichloroethane	ND	ug/l	1.5				
Tetrachloroethene	ND	ug/l	1.0				
Chlorobenzene	ND	ug/l	3.5				
Trichlorofluoromethane	ND	ug/l	5.0				
1,2-Dichloroethane	ND	ug/l	1.0				
1,1,1-Trichloroethane	ND	ug/l	1.0				
Bromodichloromethane	ND	ug/l	1.0				
trans-1,3-Dichloropropene	ND	ug/l	1.0				
cis-1,3-Dichloropropene	ND	ug/l	1.0				
1,1-Dichloropropene	ND	ug/l	25.				
Bromoform	ND	ug/l	1.0				
1,1,2,2-Tetrachloroethane	ND	ug/l	1.0				
Benzene	ND	ug/l	1.0				
Toluene	ND	ug/l	1.5				
Ethylbenzene	ND	ug/l	1.0				
Chloromethane	ND	ug/l	10.				
Bromomethane	ND	ug/l	2.0				
Vinyl chloride	ND	ug/l	2.0				
Chloroethane	ND	ug/l	2.0				
1,1-Dichloroethene	ND	ug/l	1.5				
trans-1,2-Dichloroethene	ND	ug/l	1.5				
Trichloroethene	ND	ug/l	1.0				
1,2-Dichlorobenzene	ND	ug/l	5.0				
1,3-Dichlorobenzene	ND	ug/l	5.0				
1,4-Dichlorobenzene	ND	ug/l	5.0				
Methyl tert butyl ether	ND	ug/l	10.				
p/m-Xylene	ND	ug/l	1.0				
o-Xylene	ND	ug/l	1.0				
cis-1,2-Dichloroethene	ND	ug/l	1.0				
Dibromomethane	ND	ug/l	10.				
1,4-Dichlorobutane	ND	ug/l	10.				
Iodomethane	ND	ug/l	10.				

Comments: Complete list of References and Glossary of Terms found in Addendum I

ALPHA ANALYTICAL LABORATORIES  
CERTIFICATE OF ANALYSIS

Laboratory Sample Number: L0006658-04  
TRIP BLANK

PARAMETER	RESULT	UNITS	RDL	REF	METHOD	DATES PREP ANALYSIS	ID
Volatile Organics by GC/MS 8260 continued				1	8260B	19-Aug	BT
1,2,3-Trichloropropane	ND	ug/l	10.				
Styrene	ND	ug/l	1.0				
Dichlorodifluoromethane	ND	ug/l	10.				
Acetone	ND	ug/l	10.				
Carbon disulfide	ND	ug/l	10.				
2-Butanone	ND	ug/l	10.				
Vinyl acetate	ND	ug/l	10.				
4-Methyl-2-pentanone	ND	ug/l	10.				
2-Hexanone	ND	ug/l	10.				
Ethyl methacrylate	ND	ug/l	10.				
Acrolein	ND	ug/l	25.				
Acrylonitrile	ND	ug/l	10.				
Bromochloromethane	ND	ug/l	5.0				
Tetrahydrofuran	ND	ug/l	20.				
2,2-Dichloropropane	ND	ug/l	5.0				
1,2-Dibromoethane	ND	ug/l	5.0				
1,3-Dichloropropane	ND	ug/l	5.0				
1,1,1,2-Tetrachloroethane	ND	ug/l	5.0				
Bromobenzene	ND	ug/l	5.0				
n-Butylbenzene	ND	ug/l	5.0				
sec-Butylbenzene	ND	ug/l	5.0				
tert-Butylbenzene	ND	ug/l	5.0				
o-Chlorotoluene	ND	ug/l	5.0				
p-Chlorotoluene	ND	ug/l	5.0				
1,2-Dibromo-3-chloropropane	ND	ug/l	5.0				
Hexachlorobutadiene	ND	ug/l	5.0				
Isopropylbenzene	ND	ug/l	5.0				
p-Isopropyltoluene	ND	ug/l	5.0				
Naphthalene	ND	ug/l	5.0				
n-Propylbenzene	ND	ug/l	5.0				
1,2,3-Trichlorobenzene	ND	ug/l	5.0				
1,2,4-Trichlorobenzene	ND	ug/l	5.0				
1,3,5-Trimethylbenzene	ND	ug/l	5.0				
1,2,4-Trimethylbenzene	ND	ug/l	5.0				
trans-1,4-Dichloro-2-butene	ND	ug/l	5.0				
Ethyl ether	ND	ug/l	25.				
Surrogate Recovery							
1,2-Dichloroethane-d4	121.	%					
Toluene-d8	96.0	%					
4-Bromofluorobenzene	101.	%					
Dibromofluoromethane	108.	%					

Comments: Complete list of References and Glossary of Terms found in Addendum I

# ALPHA Analytical Laboratories, Inc.

Eight Walkup Drive Westborough, MA 01581  
 PH: 508.898.9220 FAX: 508.898.9193 www.alpha-lab.com

Client Name: TOWN OF EAST HADDAM  
 Client Address: 7 MAIN ST.  
 EAST HADDAM, CT 06423  
 Phone #: FAX #:

## CHAIN OF CUSTODY

No 2204

Sheet 1 of 1

Project Name: 7 MAIN  
 Project Location: E. HADDAM  
 Project #: E00199-04  
 Project Manager: M. BAETOS

Report To: M. BAETOS  
 Bill To: JAMES VENTRES  
 TOWN OF E. HADDAM  
 PO#:

ALPHA Job #:

000658

Date Rec'd in Lab: 8/10

Date Due: 8/24

Standard TAT  
 RUSH TAT  
 (= DAYS)  
 FAX Results  
 State Forms  
 Smart Report

Comments (Please note specific method, detection limit or reporting requirements.)

CONTACT: M. BAETOS  
 LAND-TECH CONSULTANTS, INC.  
 205 PLAYHOUSE DRIVE  
 SOUTHBURY CT 06488  
 203.264.8300

### ANALYSIS REQUEST

ALPHA Lab #	Sample ID	Matrix/Source *	Sampling Date	Sampling Time	Sampler's Initials	Solubles: Field Filtered (Y/N)	TPH-12	REA-2 (Total)
66581	MW-1	GW	8/9/00		MJB	N	X	X
2	MW-2	GW				N	X	X
3	MW-3	GW				N	X	X
4	TRIP BLANK		7/24/00	1415			X	

# of Containers: 7 6 3  
 Container Type: Y A P  
 Preservative: B B C \*

Transfers Accepted By:	Date	Time
<i>[Signature]</i>	8/10	10:00
<i>[Signature]</i>	8/10	4:00
<i>[Signature]</i>	8/10	1845

All samples submitted are subject to Alpha's standard Terms and Conditions.  
 \* See Reverse side for Matrix, Container, and Preservative Codes.  
 Form No.: 01-01



**Environmental Laboratories, Inc.**

587 East Middle Turnpike, P.O. Box 418, Manchester, CT 06040-0418  
Tel. (860) 645-1102 Fax (860) 645-0823

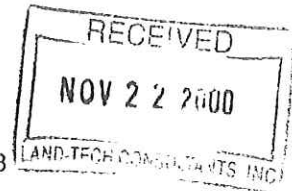

November 21, 2000

Land-Tech Consultants, Inc.  
205 Playhouse Corner  
Southbury CT 06488

Attention: Mr. Michael Bartos, Jr.

Sample ID#: AD00753-56

This laboratory is in compliance with the QA/QC procedure outlined in EPA 600/4-79-019, Handbook for Analytical Quality in Water and Waste Water, March 1979, and SW846 QA/QC requirements of procedures used.

This report, starting with the cover sheet ending with the chain of custody, consists of 9 pages.

If you have any questions concerning this testing, please do not hesitate to contact Phoenix Client Services at ext. 200.

Sincerely yours,

Phyllis Shiller  
Laboratory Director

CT Lab Registration #PH-0618  
MA Lab Registration #MA-CT-007  
NY Lab Registration #11301  
RI Lab Registration #63  
NH Lab Registration #213693-A,B  
ME Lab Registration #CT-007



Environmental Laboratories, Inc.

587 East Middle Turnpike, P.O. Box 418, Manchester, CT 06040  
Tel. (860) 645-1102 Fax (860) 645-0823

Analysis Report  
November 21, 2000

FOR: Attn: Mr. Michael Bartos, Jr.  
Land-Tech Consultants, Inc.  
205 Playhouse Corner  
Southbury, CT 06488

Sample Information

Matrix: WATER  
Location Code: LANDTECH  
Project Code:  
P.O.#:

Custody Information

Collected by:  
Received by: SW  
Analyzed by: see below

Date Time  
11/15/00 0:00  
11/16/00 17:00

Laboratory Data

Client ID: 7 MAIN MW-1

Phoenix I.D. AD00753

Parameter	Result	RL	Units	Date	Time by	Reference
Pesticide Extraction	Completed			11/16/00	20:58 PL	SW846-3510
<u>Pesticide</u>						
4,4' -DDD	ND	0.1	ug/L	11/20/00	9:42 KCA	608/8081
4,4' -DDE	ND	0.1	ug/L	11/20/00	9:42 KCA	608/8081
4,4' -DDT	ND	0.1	ug/L	11/20/00	9:42 KCA	608/8081
a-BHC	ND	0.05	ug/L	11/20/00	9:42 KCA	608/8081
Aldrin	ND	0.05	ug/L	11/20/00	9:42 KCA	608/8081
b-BHC	ND	0.05	ug/L	11/20/00	9:42 KCA	608/8081
Chlordane	ND	0.3	ug/L	11/20/00	9:42 KCA	608/8081
d-BHC	ND	0.05	ug/L	11/20/00	9:42 KCA	608/8081
Dieldrin	ND	0.1	ug/L	11/20/00	9:42 KCA	608/8081
Endosulfan I	ND	0.05	ug/L	11/20/00	9:42 KCA	608/8081
Endosulfan II	ND	0.1	ug/L	11/20/00	9:42 KCA	608/8081
Endosulfan Sulfate	ND	0.1	ug/L	11/20/00	9:42 KCA	608/8081
Endrin	ND	0.1	ug/L	11/20/00	9:42 KCA	608/8081
Endrin Aldehyde	ND	0.1	ug/L	11/20/00	9:42 KCA	608/8081
g-BHC (Lindane)	ND	0.05	ug/L	11/20/00	9:42 KCA	608/8081
Heptachlor	ND	0.05	ug/L	11/20/00	9:42 KCA	608/8081
Heptachlor epoxide	ND	0.05	ug/L	11/20/00	9:42 KCA	608/8081
Methoxychlor	ND	0.2	ug/L	11/20/00	9:42 KCA	608/8081
Toxaphene	ND	1.0	ug/L	11/20/00	9:42 KCA	608/8081



---

**Comments:**

ND=Not detected BDL = Below Detection Limit RL=Reporting Limit

If there are any questions regarding this data, please call Phoenix Client Services at extension 200.

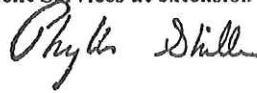

Phyllis Shiller, Laboratory Director  
November 21, 2000



Environmental Laboratories, Inc.

587 East Middle Turnpike, P.O. Box 418, Manchester, CT 06040  
Tel. (860) 645-1102 Fax (860) 645-0823

# Analysis Report

November 21, 2000

FOR: Attn: Mr. Michael Bartos, Jr.  
Land-Tech Consultants, Inc.  
205 Playhouse Corner  
Southbury, CT 06488

### Sample Information

Matrix: WATER  
Location Code: LANDTECH  
Project Code:  
P.O.#:

### Custody Information

Collected by:  
Received by: SW  
Analyzed by: see below

### Date

11/15/00  
11/16/00

### Time

0:00  
17:00

## Laboratory Data

Client ID: 7 MAIN MW-2

Phoenix I.D. AD00754

Parameter	Result	RL	Units	Date	Time	by	Reference
Pesticide Extraction	Completed			11/16/00	20:58	PL	SW846-3510
<b><u>Pesticide</u></b>							
4,4' -DDD	ND	0.1	ug/L	11/20/00	9:42	KCA	608/8081
4,4' -DDE	ND	0.1	ug/L	11/20/00	9:42	KCA	608/8081
4,4' -DDT	ND	0.1	ug/L	11/20/00	9:42	KCA	608/8081
a-BHC	ND	0.05	ug/L	11/20/00	9:42	KCA	608/8081
Aldrin	ND	0.05	ug/L	11/20/00	9:42	KCA	608/8081
b-BHC	ND	0.05	ug/L	11/20/00	9:42	KCA	608/8081
Chlordane	ND	0.3	ug/L	11/20/00	9:42	KCA	608/8081
d-BHC	ND	0.05	ug/L	11/20/00	9:42	KCA	608/8081
Dieldrin	ND	0.1	ug/L	11/20/00	9:42	KCA	608/8081
Endosulfan I	ND	0.05	ug/L	11/20/00	9:42	KCA	608/8081
Endosulfan II	ND	0.1	ug/L	11/20/00	9:42	KCA	608/8081
Endosulfan Sulfate	ND	0.1	ug/L	11/20/00	9:42	KCA	608/8081
Endrin	ND	0.1	ug/L	11/20/00	9:42	KCA	608/8081
Endrin Aldehyde	ND	0.1	ug/L	11/20/00	9:42	KCA	608/8081
g-BHC (Lindane)	ND	0.05	ug/L	11/20/00	9:42	KCA	608/8081
Heptachlor	ND	0.05	ug/L	11/20/00	9:42	KCA	608/8081
Heptachlor epoxide	ND	0.05	ug/L	11/20/00	9:42	KCA	608/8081
Methoxychlor	ND	0.2	ug/L	11/20/00	9:42	KCA	608/8081
Toxaphene	ND	1.0	ug/L	11/20/00	9:42	KCA	608/8081

---

**Comments:**

ND=Not detected BDL = Below Detection Limit RL=Reporting Limit

If there are any questions regarding this data, please call Phoenix Client Services at extension 200.

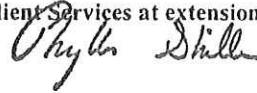

Phyllis Shiller, Laboratory Director  
November 21, 2000



Environmental Laboratories, Inc.

587 East Middle Turnpike, P.O. Box 418, Manchester, CT 06040  
Tel. (860) 645-1102 Fax (860) 645-0823

# Analysis Report

November 21, 2000

FOR: Attn: Mr. Michael Bartos, Jr.  
Land-Tech Consultants, Inc.  
205 Playhouse Corner  
Southbury, CT 06488

### Sample Information

Matrix: WATER  
Location Code: LANDTECH  
Project Code:  
P.O.#:

### Custody Information

Collected by:  
Received by: SW  
Analyzed by: see below

### Date

11/15/00 0:00  
11/16/00 17:00

### Time

## Laboratory Data

Client ID: 7 MAIN MW-3

Phoenix I.D. AD00755

Parameter	Result	RL	Units	Date	Time	by	Reference
Pesticide Extraction	Completed			11/16/00	20:58	PL	SW846-3510
<u>Pesticide</u>							
4,4' -DDD	ND	0.1	ug/L	11/20/00	9:42	KCA	608/8081
4,4' -DDE	ND	0.1	ug/L	11/20/00	9:42	KCA	608/8081
4,4' -DDT	ND	0.1	ug/L	11/20/00	9:42	KCA	608/8081
a-BHC	ND	0.05	ug/L	11/20/00	9:42	KCA	608/8081
Aldrin	ND	0.05	ug/L	11/20/00	9:42	KCA	608/8081
b-BHC	ND	0.05	ug/L	11/20/00	9:42	KCA	608/8081
Chlordane	ND	0.3	ug/L	11/20/00	9:42	KCA	608/8081
d-BHC	ND	0.05	ug/L	11/20/00	9:42	KCA	608/8081
Dieldrin	ND	0.1	ug/L	11/20/00	9:42	KCA	608/8081
Endosulfan I	ND	0.05	ug/L	11/20/00	9:42	KCA	608/8081
Endosulfan II	ND	0.1	ug/L	11/20/00	9:42	KCA	608/8081
Endosulfan Sulfate	ND	0.1	ug/L	11/20/00	9:42	KCA	608/8081
Endrin	ND	0.1	ug/L	11/20/00	9:42	KCA	608/8081
Endrin Aldehyde	ND	0.1	ug/L	11/20/00	9:42	KCA	608/8081
g-BHC (Lindane)	ND	0.05	ug/L	11/20/00	9:42	KCA	608/8081
Heptachlor	ND	0.05	ug/L	11/20/00	9:42	KCA	608/8081
Heptachlor epoxide	ND	0.05	ug/L	11/20/00	9:42	KCA	608/8081
Methoxychlor	ND	0.2	ug/L	11/20/00	9:42	KCA	608/8081
Toxaphene	ND	1.0	ug/L	11/20/00	9:42	KCA	608/8081

---

**Comments:**

ND=Not detected BDL = Below Detection Limit RL=Reporting Limit

If there are any questions regarding this data, please call Phoenix Client Services at extension 200.

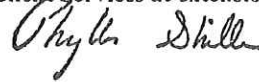

Phyllis Shiller, Laboratory Director  
November 21, 2000



Environmental Laboratories, Inc.

587 East Middle Turnpike, P.O. Box 418, Manchester, CT 06040  
Tel. (860) 645-1102 Fax (860) 645-0823

## QC Report

AD00756

November 21, 2000

Sample ID AD00756

Analyte	Method		Matrix		RPD
	Blank	Spike	Spike	Dup.	
	(ppb)	(% Rec)	(% Rec.)		
-					
g-BHC	ND	73%	82%	12%	
Heptachlor	ND	70%	81%	15%	
Aldrin	ND	69%	81%	16%	
Dieldrin	ND	80%	90%	12%	
Endrin	ND	92%	99%	7%	
4,4'-DDT	ND	94%	94%	11%	

If there are any questions regarding this data, please call Phoenix Client Services at extension 200.

Phyllis Shiller  
Laboratory Director



**Environmental Laboratories, Inc.**

587 East Middle Turnpike, P.O. Box 418, Manchester, CT 06040  
 Tel. (860) 645-1102 Fax (860) 645-0823

**CHAIN OF CUSTODY RECORD**

DATE RCVD: \_\_\_\_\_

Client Services (860) 645-8726

Customer: TOWN OF EAST HADDAM Project: 7 FISH  
 Address: 7 MAIN ST. Report To: N.A. BASTON LAND TECH  
E. HADDAM CT 06423 Invoice To: J. VENTRES E. HADDAM

Project P.O.: \_\_\_\_\_  
 Phone #: (860) 645-8300  
 Fax #: (860) 645-0823

**Client Sample - Information - Identification**

Item #	Customer's Sample Ident	Sample Matrix	Date	Date	Time
1	MW-1	GM	1/2/02		
2	MW-2	↓			
3	MW-3	↓			

**Analysis Requested**

RESTRICTED USE	VOATMS							
	PHENIX							
	GLYCOL							
	GLYCOL							
	PHENIX SAMPLE #	00753						
	PHENIX SAMPLE #	00754						
	PHENIX SAMPLE #	00755						
	PHENIX SAMPLE #	00756						

Comments:

Item #	Relinquished by:	Accepted by:	Date:	Time:
1-3	<i>M. Savino</i>	<i>John Kelly</i>	1/5/02	12:10
1-3	<i>John Kelly</i>	<i>J.B. Rubato</i>	11/10/02	17:00

Standard lab turnaround is 10 working days. Accelerated turnarounds are always available. Check with office on prevailing surcharge. ACCELERATED TURN-AROUND TIME REQUESTED: 1 2 3 4 5 working days.

ALPHA ANALYTICAL LABORATORIES

Eight Walkup Drive  
Westborough, Massachusetts 01581-1019  
(508) 898-9220

MA:M-MA-086 NH:200395-B/C CT:PH-0574 ME:MA086 RI:65 NY:11148

CERTIFICATE OF ANALYSIS

Client: Land-Tech Consultants Laboratory Job Number: L0006331  
Address: 205 Playhouse Corner Invoice Number: 39781  
Southbury, CT 06488 Date Received: 02-AUG-00  
Attn: M. Bartos Date Reported: 15-AUG-00  
Project Number: E00199-04 Delivery Method: Alpha  
Site: 7 MAIN ST.

---

ALPHA SAMPLE NUMBER	CLIENT IDENTIFICATION	SAMPLE LOCATION
L0006331-01	MW-2-6	E. HADDAM, CT
L0006331-02	MW-3-6	E. HADDAM, CT

I attest under the pains and penalties of perjury that, based upon my inquiry of those individuals immediately responsible for obtaining the information, the material contained in this report is, to the best of my knowledge and belief, accurate and complete. This certificate of analysis is not complete unless this page accompanies any and all pages of this report.

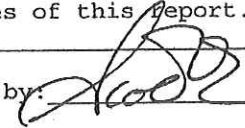
Authorized by: 

Scott McLean - Laboratory Director



ALPHA ANALYTICAL LABORATORIES  
 CERTIFICATE OF ANALYSIS

MA:M-MA-086 NH:200395-B/C CT:PH-0574 ME:MA086 RI:65

Laboratory Sample Number: L0006331-01 Date Collected: 28-JUL-2000  
 MW-2-6 Date Received : 02-AUG-2000  
 Sample Matrix: SOIL Date Reported : 15-AUG-00  
 Condition of Sample: Satisfactory Field Prep: None

Number & Type of Containers: 1-Amber,1-Vial

PARAMETER	RESULT	UNITS	RDL	REF	METHOD	DATES		ID
						PREP	ANALYSIS	
Solids, Total	81.	%	0.10	30	2540G		05-Aug	LC
Hydrocarbons, Total (IR)	200	mg/kg	49.	4	418.1		14-Aug	14-Aug TH
Total Metals				1	3051			
Arsenic, Total	3.5	mg/kg	0.49	1	6010B		11-Aug	13-Aug MG
Barium, Total	28.	mg/kg	0.49	1	6010B		11-Aug	13-Aug MG
Cadmium, Total	ND	mg/kg	0.49	1	6010B		11-Aug	13-Aug MG
Chromium, Total	18.	mg/kg	0.49	1	6010B		11-Aug	13-Aug MG
Lead, Total	31.	mg/kg	2.4	1	6010B		11-Aug	13-Aug MG
Mercury, Total	ND	mg/kg	0.31	1	7471A		11-Aug	12-Aug DM
Selenium, Total	ND	mg/kg	0.98	1	6010B		11-Aug	13-Aug MG
Silver, Total	ND	mg/kg	0.49	1	6010B		11-Aug	13-Aug MG
TCLP Metals								
TCLP Extraction				1	1311		10-Aug	
Arsenic, TCLP	ND	mg/l	1.0	1	6010B		11-Aug	14-Aug MM
Barium, TCLP	ND	mg/l	0.50	1	6010B		11-Aug	14-Aug MM
Cadmium, TCLP	ND	mg/l	0.10	1	6010B		11-Aug	14-Aug MM
Chromium, TCLP	ND	mg/l	0.20	1	6010B		11-Aug	14-Aug MM
Lead, TCLP	ND	mg/l	0.50	1	6010B		11-Aug	14-Aug MM
Mercury, TCLP	ND	mg/l	0.005	1	7470A		13-Aug	14-Aug DM
Selenium, TCLP	ND	mg/l	1.0	1	6010B		11-Aug	14-Aug MM
Silver, TCLP	ND	mg/l	0.10	1	6010B		11-Aug	14-Aug MM
Volatile Organics by GC/MS 8260				1	8260B			09-Aug MD
Methylene chloride	ND	ug/kg	31.					
1,1-Dichloroethane	ND	ug/kg	9.2					
Chloroform	ND	ug/kg	9.2					
Carbon tetrachloride	ND	ug/kg	6.2					
1,2-Dichloropropane	ND	ug/kg	22.					
Dibromochloromethane	ND	ug/kg	6.2					
1,1,2-Trichloroethane	ND	ug/kg	9.2					
Tetrachloroethene	ND	ug/kg	6.2					
Chlorobenzene	ND	ug/kg	22.					

Comments: Complete list of References and Glossary of Terms found in Addendum I

ALPHA ANALYTICAL LABORATORIES  
 CERTIFICATE OF ANALYSIS

MA:M-MA-086 NH:200395-B/C CT:PH-0574 ME:MA086 RI:65

Laboratory Sample Number: L0006331-02

Date Collected: 01-AUG-2000

MW-3-6

Date Received : 02-AUG-2000

Sample Matrix:

SOIL

Date Reported : 15-AUG-00

Condition of Sample: Satisfactory

Field Prep: None

Number & Type of Containers: 1-Amber,1-Vial

PARAMETER	RESULT	UNITS	RDL	REF	METHOD	DATES PREP ANALYSIS	ID
Solids, Total	85.	%	0.10	30	2540G	14-Aug	EO
Hydrocarbons, Total(IR)	54.	mg/kg	47.	4	418.1	14-Aug 14-Aug	TH
Total Metals				1	3051		
Arsenic, Total	5.6	mg/kg	0.47	1	6010B	11-Aug 13-Aug	MG
Barium, Total	33.	mg/kg	0.47	1	6010B	11-Aug 13-Aug	MG
Cadmium, Total	ND	mg/kg	0.47	1	6010B	11-Aug 13-Aug	MG
Chromium, Total	28.	mg/kg	0.47	1	6010B	11-Aug 13-Aug	MG
Lead, Total	8.5	mg/kg	2.3	1	6010B	11-Aug 13-Aug	MG
Mercury, Total	ND	mg/kg	0.29	1	7471A	11-Aug 12-Aug	DM
Selenium, Total	ND	mg/kg	0.94	1	6010B	11-Aug 13-Aug	MG
Silver, Total	ND	mg/kg	0.47	1	6010B	11-Aug 13-Aug	MG
TCLP Metals							
TCLP Extraction				1	1311	10-Aug	
Arsenic, TCLP	ND	mg/l	1.0	1	6010B	11-Aug 14-Aug	MM
Barium, TCLP	ND	mg/l	0.50	1	6010B	11-Aug 14-Aug	MM
Cadmium, TCLP	ND	mg/l	0.10	1	6010B	11-Aug 14-Aug	MM
Chromium, TCLP	ND	mg/l	0.20	1	6010B	11-Aug 14-Aug	MM
Lead, TCLP	ND	mg/l	0.50	1	6010B	11-Aug 14-Aug	MM
Mercury, TCLP	ND	mg/l	0.005	1	7470A	13-Aug 14-Aug	DM
Selenium, TCLP	ND	mg/l	1.0	1	6010B	11-Aug 14-Aug	MM
Silver, TCLP	ND	mg/l	0.10	1	6010B	11-Aug 14-Aug	MM
Volatile Organics by GC/MS 8260				1	8260B	13-Aug	BT
Methylene chloride	ND	ug/kg	31.				
1,1-Dichloroethane	ND	ug/kg	9.2				
Chloroform	ND	ug/kg	9.2				
Carbon tetrachloride	ND	ug/kg	6.1				
1,2-Dichloropropane	ND	ug/kg	21.				
Dibromochloromethane	ND	ug/kg	6.1				
1,1,2-Trichloroethane	ND	ug/kg	9.2				
Tetrachloroethene	ND	ug/kg	6.1				
Chlorobenzene	ND	ug/kg	21.				

Comments: Complete list of References and Glossary of Terms found in Addendum I

ALPHA ANALYTICAL LABORATORIES  
CERTIFICATE OF ANALYSIS

Laboratory Sample Number: L0006331-02  
MW-3-6

PARAMETER	RESULT	UNITS	RDL	REF	METHOD	DATES PREP ANALYSIS	ID
Volatile Organics by GC/MS 8260 continued				1	8260B	13-Aug	BT
Trichlorofluoromethane	ND	ug/kg	31.				
1,2-Dichloroethane	ND	ug/kg	6.1				
1,1,1-Trichloroethane	ND	ug/kg	6.1				
Bromodichloromethane	ND	ug/kg	6.1				
trans-1,3-Dichloropropene	ND	ug/kg	6.1				
cis-1,3-Dichloropropene	ND	ug/kg	6.1				
1,1-Dichloropropene	ND	ug/kg	150				
Bromoform	ND	ug/kg	6.1				
1,1,2,2-Tetrachloroethane	ND	ug/kg	6.1				
Benzene	ND	ug/kg	6.1				
Toluene	ND	ug/kg	9.2				
Ethylbenzene	ND	ug/kg	6.1				
Chloromethane	ND	ug/kg	61.				
Bromomethane	ND	ug/kg	12.				
Vinyl chloride	ND	ug/kg	12.				
Chloroethane	ND	ug/kg	12.				
1,1-Dichloroethene	ND	ug/kg	9.2				
trans-1,2-Dichloroethene	ND	ug/kg	9.2				
Trichloroethene	ND	ug/kg	6.1				
1,2-Dichlorobenzene	ND	ug/kg	31.				
1,3-Dichlorobenzene	ND	ug/kg	31.				
1,4-Dichlorobenzene	ND	ug/kg	31.				
Methyl tert butyl ether	ND	ug/kg	61.				
p/m-Xylene	ND	ug/kg	6.1				
o-Xylene	ND	ug/kg	6.1				
cis-1,2-Dichloroethene	ND	ug/kg	6.1				
Dibromomethane	ND	ug/kg	61.				
1,4-Dichlorobutane	ND	ug/kg	61.				
Iodomethane	ND	ug/kg	61.				
1,2,3-Trichloropropane	ND	ug/kg	61.				
Styrene	ND	ug/kg	6.1				
Dichlorodifluoromethane	ND	ug/kg	61.				
Acetone	ND	ug/kg	61.				
Carbon disulfide	ND	ug/kg	61.				
2-Butanone	ND	ug/kg	61.				
Vinyl acetate	ND	ug/kg	61.				
4-Methyl-2-pentanone	ND	ug/kg	61.				
2-Hexanone	ND	ug/kg	61.				
Ethyl methacrylate	ND	ug/kg	61.				
Acrolein	ND	ug/kg	150				
Acrylonitrile	ND	ug/kg	61.				
Bromochloromethane	ND	ug/kg	31.				
Tetrahydrofuran	ND	ug/kg	120				
2,2-Dichloropropane	ND	ug/kg	31.				
1,2-Dibromoethane	ND	ug/kg	31.				
1,3-Dichloropropane	ND	ug/kg	31.				
1,1,1,2-Tetrachloroethane	ND	ug/kg	31.				
Bromobenzene	ND	ug/kg	31.				
n-Butylbenzene	ND	ug/kg	31.				

Comments: Complete list of References and Glossary of Terms found in Addendum I

ALPHA ANALYTICAL LABORATORIES  
CERTIFICATE OF ANALYSIS

Laboratory Sample Number: L0006331-02  
MW-3-6

PARAMETER	RESULT	UNITS	RDL	REF	METHOD	DATES PREP ANALYSIS	ID
Volatile Organics by GC/MS 8260 continued				1	8260B	13-Aug	BT
sec-Butylbenzene	ND	ug/kg	31.				
tert-Butylbenzene	ND	ug/kg	31.				
o-Chlorotoluene	ND	ug/kg	31.				
p-Chlorotoluene	ND	ug/kg	31.				
1,2-Dibromo-3-chloropropane	ND	ug/kg	31.				
Hexachlorobutadiene	ND	ug/kg	31.				
Isopropylbenzene	ND	ug/kg	31.				
p-Isopropyltoluene	ND	ug/kg	31.				
Naphthalene	ND	ug/kg	31.				
n-Propylbenzene	ND	ug/kg	31.				
1,2,3-Trichlorobenzene	ND	ug/kg	31.				
1,2,4-Trichlorobenzene	ND	ug/kg	31.				
1,3,5-Trimethylbenzene	ND	ug/kg	31.				
1,2,4-Trimethylbenzene	ND	ug/kg	31.				
trans-1,4-Dichloro-2-butene	ND	ug/kg	31.				
Ethyl ether	ND	ug/kg	150				
Surrogate Recovery							
1,2-Dichloroethane-d4	94.0	%					
Toluene-d8	97.0	%					
1-Bromofluorobenzene	103.	%					
1-Bromofluoromethane	86.0	%					

Comments: Complete list of References and Glossary of Terms found in Addendum I

# ALPHA Analytical Laboratories, Inc.

Eight Walkup Drive Westborough, MA 01581  
PH: 508.898.9220 FAX: 508.898.9193 www.alpha lab.com

Client Name: TOWN OF EAST HADDAM

Client Address: 7 MAIN ST.  
E. HADDAM CT 06423

Phone #: FAX #:

Comments (Please note specific method, detection limit or reporting requirements.)

CONTACT: M. BARTOS  
LAND-TECH CONSULTANTS, INC.  
205 PLAYHOUSE CORNER,  
SOUTHBRURY, CT 06488  
PH: 203-264-8300

## CHAIN OF CUSTODY

No 2203

Sheet 1 of 1

Project Name: 7 MAIN

Project Location: E. HADDAM

Project #: E00199-04

Project Manager: M. BARTOS

Report To: M. BARTOS (SEE COMMENTS)

Bill To: JAMES VENTRES  
TOWN OF E. HADDAM

PO#:

ALPHA Job #:

0066331

Date Rec'd in Lab: 8/2

Date Due: 8/16

Standard TAT  
 RUSH TAT (5 DAYS)

FAX Results  
 State Forms  
 Smart Report

### ANALYSIS REQUEST

ALPHA Lab #	Sample ID	Matrix/Source *	Sampling Date	Sampling Time	Sampler's Initials	Solubles: Field Filtered (Y/N)	8260	TRH-12	RCEA-8 + TCLP
63311	MW-2-6	S	7/29/00		MJB		X	X	X
2	MW-3-6	S	8/1/00				X	X	

All samples submitted are subject to Alpha's standard Terms and Conditions.

\* See Reverse for Matrix, Container, and Preservative Codes.

Form No.: 01-01

# of Containers: 2 2 2

Container Type: 9 A A

Preservative: \* A A A

Transfers Relinquished By:	Transfers Accepted By:	Date	Time
M. Bartos	Frank	8/2	1:30
	J. Ventres	8/16	2:30

**Appendix B**

Sanitary Sewer Connection Records

June 14, 1971

PAGE 1

# 1468-5

APPLICATION FOR PERMIT

FOR CONSTRUCTION ALTERATION OR REPAIR  
OF A PRIVATE SEWERAGE DISPOSAL SYSTEM

FEE \$5.00

VYNIALEK BROS.  
INC.

358680

STATE OF  
CONN.  
OWNER

STATE HIGHWAY GARAGE  
BY BRIDGE  
WORK LOCATION

CONTRACTOR

LICENSE NO.

Main St

SKETCH OF SITE

SHOWING:

1. Boundaries within 200'
2. Well locations with 200'
3. Building to be served
4. Location of existing sewer, if any
5. Location of deep test hole/holes and percolation test hole/holes

*Completed*

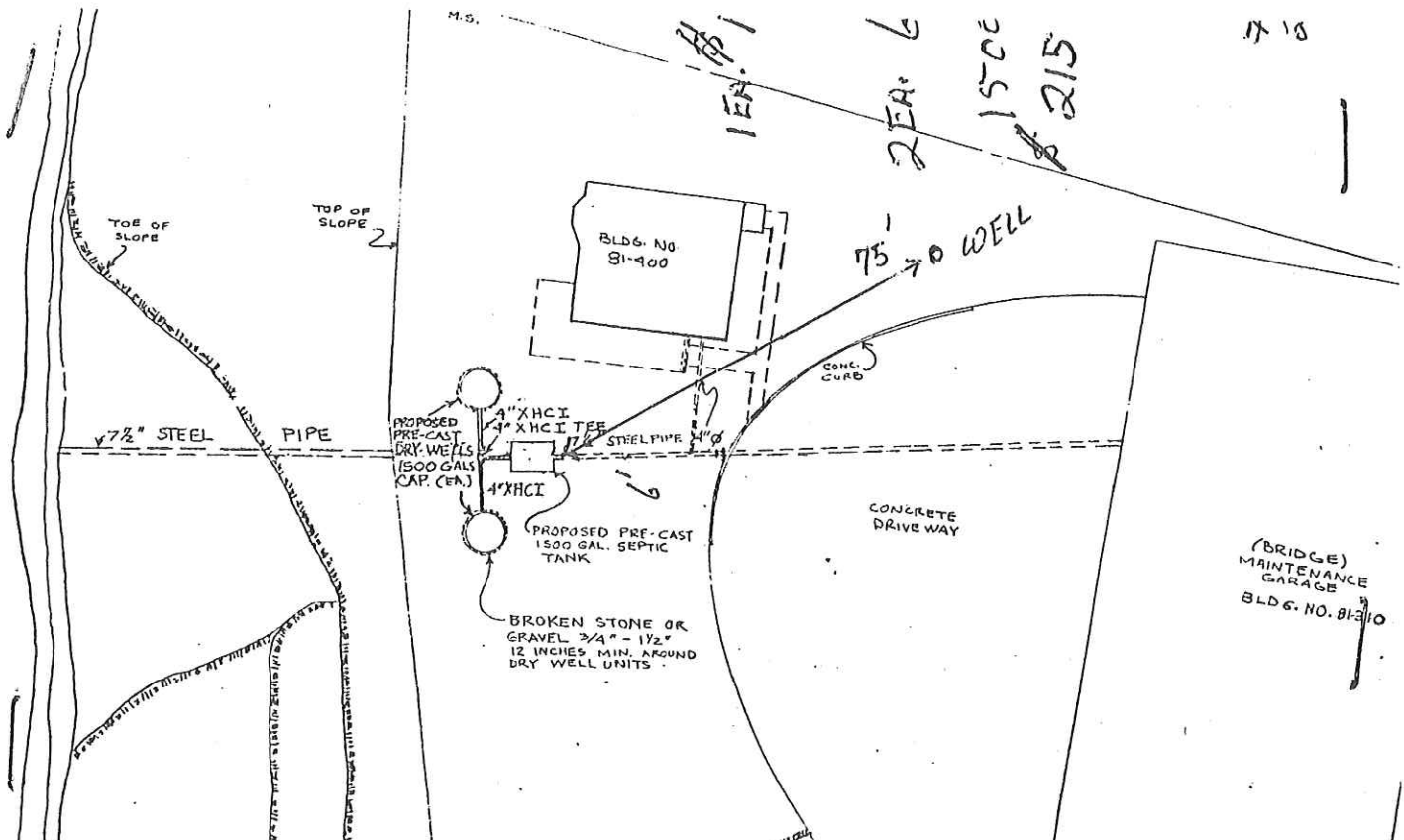

PAGE 2

PERMIT FOR CONSTRUCTION OF ALTERATION OR REPAIR  
PRIVATE SEWERAGE DISPOSAL SYSTEM

INSPECTION #1

SANITARIANS REPORT ON TEST HOLES.

*No Inspection*

DESCRIPTION OF WORK TO BE DONE INCLUDING DETAILED PLAN  
(Location may be added to sketch on page 1)

*INSTALL 1500 GAL. TANK*

*" 2 ~~2~~ 6X8 DRYWELL*

INSPECTION #2

ALL EXCAVATIONS OPEN

*No Inspection*

INSPECTION #3

WORK COMPLETE EXCEPT FOR BACKFILL

*Dry wells To Close Together*

*This Job was Controlled  
By State Highway Engineers  
With No Cooperation With Town  
Officials*

APPROVED *m. l. d. m.*  
DISAPPROVED

DATE 8/3/71



17/15

EAST HADDAM WATER POLLUTION CONTROL AUTHORITY  
TOWN OF EAST HADDAM

(860) 873-5031

HOURS: Mon., Wed., & Thurs 9AM-4PM / Tues. 9AM-7PM / FRI. 9AM-12 NOON

June 21, 1999

Town Department of Public Works/Mark Kiefer  
PO Box K  
East Haddam, CT 06423

RE: Sewer Hook-up - 7 Main St

Dear Mr. Kiefer - (Jim told me to - reminder note);

The East Haddam Water Pollution Control Authority (WPCA) gave official notice to hook-up to the collection system and the grinder pump in December of 1997. One year and six months have expired since the original notice. Your property is one of twenty that have not connected as of June 10, 1999. In a February letter, you were given until April 1, 1999 to complete the required hook ups. After April 1, 1999, any additional cost incurred due to construction deficiencies was to be at the expense of the property owner(s). The reason that you have been asked to connect is that there is a potential of deficiencies in the installation of the grinder pump system. At this time, the WPCA has the authority and ability to cover the cost of correcting deficiencies by using the funds from retainage held from LaRosa Construction Company. Most of these deficiencies that have been discovered so far are faulty electrical connections costing between \$150 and \$600 to repair. These deficiencies can only be discovered when the septic system is connected to the grinder pump and tested. *The WPCA expects to release the retained funds at its meeting on July 7, 1999. Once it does so, it will lose its ability to pay for deficiencies in the grinder pump system.*

For those residents that do not hookup, please be advised that although you eventually will be ordered by the DEP and the WPCA to hook up to the sewer system, the WPCA will be removing the grinder pump mechanism. We have been notified by the grinder pump manufacturer that dormant units stored underground can be adversely effected. *The WPCA will return these grinder pump mechanisms once you are ordered to hook up but at a charge equal to the removal and installation cost. The WPCA feels that it is unfair to disperse the additional cost to the entire district for those few who refuse to hook up.*

We realize that some of the residences have contacted contractors to complete the hook ups. The WPCA would like to close out this construction contract without additional cost being left to the you, the property owner. Please contact James Ventres at the Land Use Office (873-5031) this week to update the commission on your progress and to discuss your intentions.

Sincerely,

Norman Gobelle - Chairman - E.H. Water Pollution Control Authority

7 Main St.

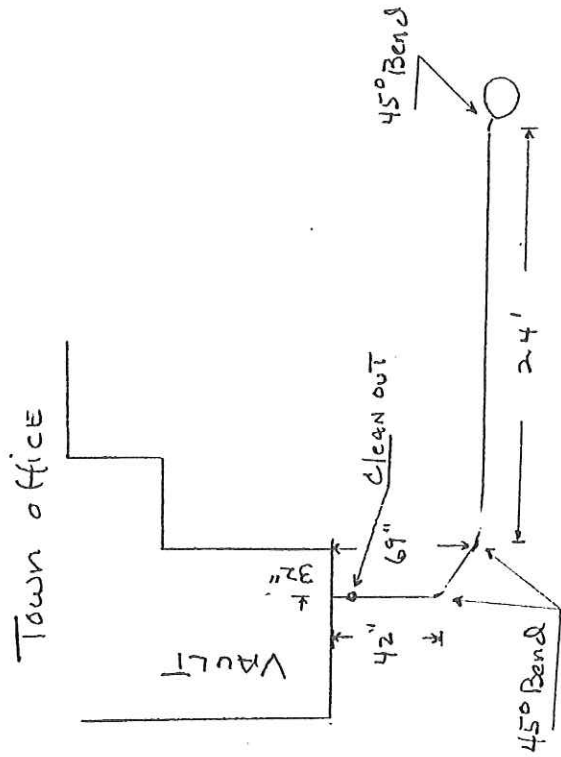

PERMIT NO. 1130-0299  
 LICENSE NO. 000813

APPLICATION FOR PLUMBING PERMIT  
 (Application must be typed or printed)

TOWN OF EAST HADDAM  
 CONNECTICUT

LOCATION OF JOB (NO. & STREET) <u>1 Main St.</u>	MAP <u>17</u>	LOT <u>14</u>
OWNER <u>Town of East Haddam</u>	ADDRESS (NO STREET, TOWN, STATE, ZIP) <u>7 Main St</u>	PHONE <u>813-5020</u>
PLUMBING CONTRACTOR	ADDRESS (NO STREET, TOWN, STATE, ZIP)	PHONE

REMARKS  
Tie into Sewer system

APPLICANT  
Peter R. Linko

ADDRESS (NO. STREET) - MUST BE COMPLETED  
16 Danvers Rd.

TOWN, STATE, ZIP  
East Haddam CT. 06423

Fee: to \$999.00 - \$10.00  
 \$5.00 for each additional \$1,000.00 or part

APPLIANCES	TYPE OF WORK BEING DONE		ESTIMATED	COST	FEE
	NO	MFR			
DISH WASHER					
GARBAGE DISPOSAL					
CLOTHES WASHER					

CLASSIFICATION  
 USE GROUP \_\_\_\_\_  
 CONSTRUCTION TYPE \_\_\_\_\_  
 SPECIFIC USE \_\_\_\_\_

ACTUAL COST: Waived

**All Permits Must Be Posted And Visible From The Street**

LICENSE # \_\_\_\_\_

WATER SUPPLY

PUMP CONTRACTOR \_\_\_\_\_ STREET \_\_\_\_\_ TOWN \_\_\_\_\_ STATE \_\_\_\_\_

WELL  SPRING  PUBLIC  ASSOCIATION IF WELL, TYPE \_\_\_\_\_ DEPTH \_\_\_\_\_ STATIC LEVEL \_\_\_\_\_

\_\_\_\_\_ GAL PER MIN AT \_\_\_\_\_ FT \_\_\_\_\_ GAL PER MIN AT \_\_\_\_\_ FT \_\_\_\_\_ GAL PER MIN AT \_\_\_\_\_ FT

PUMP MANUFACTURER \_\_\_\_\_ MODEL \_\_\_\_\_ H P \_\_\_\_\_ GPM \_\_\_\_\_ DEPTH SET \_\_\_\_\_

ELECTRICAL WORK DONE BY \_\_\_\_\_ TOWN \_\_\_\_\_ STATE \_\_\_\_\_

TYPE	WATER HEATER		PIPE			FIXTURES	
	WATER HEATER	WATER TANK	SIZE	TYPE	INSPECTED	NO	STYLE
MAKE			BURIED DRAIN			BATHTUB	
MODEL			SOIL			SHOWER	
CAPACITY			MAIN VENT			TOILET	
TEST PRESSURE			WASTE			SINK	
WORKING PRESSURE			OTHER VENT			LAVATORY	
TEMP RELIEF			COLD SUPPLY			WASH TUB	
PRESSURE RELIEF			HOT SUPPLY			URINAL	
						BIDET	

All work covered by this application has been authorized by the owner or agent of this property and will be done according to state regulations. This permit shall expire if work does not commence within 6 months.

11.30.99 Date

Peter R. Linko Applicants Signature

APPROVED  DISAPPROVED

11/30/99 Date

Wayne [Signature] Building Official

RIVER HOUSE  
SEWER

